

LOW-RISE FULL FLOOR TEST FIT 35,454 RSF

WORK PLACE		People
Private Office		25
Executive Office		10
Workstation		196
Total		231

MEET		Rooms	Seats
Board Room		1	30
Conference Room		6	52
Total		7	82

SOCIAL		Area	Seats
Reception		1	8
Pantry		2	14
Total		3	22

Total Dedicated Desks **231 People**

**Total Collaborative Seats
Open & Enclosed** **104 Seats**



LOW-RISE BLOCK TYPICAL CORE + SHELL 35,454 RSF

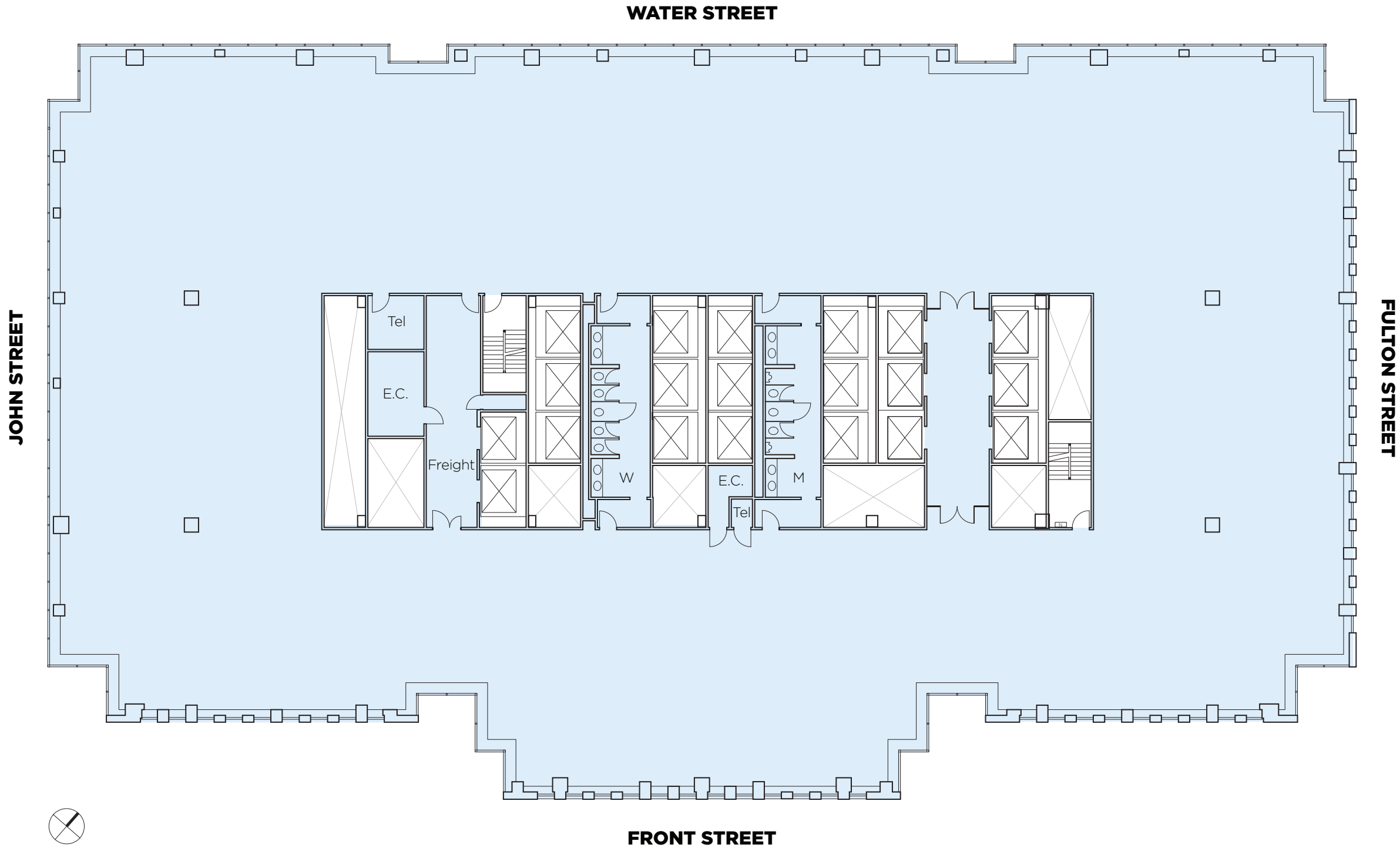

Robert A. Constable
 robert.constable@cushwake.com
 212 709 0770

Myles Fennon
 myles.fennon@cushwake.com
 212 841 7532

John Cefaly
 john.cefaly@cushwake.com
 212 841 5977

Stephen Bellwood
 stephen.bellwood@cushwake.com
 212 318 9785

Ethan Silverstein
 ethan.silverstein@cushwake.com
 212 698 2694

PARTIAL FLOOR 9 BUILD-TO-SUIT SUITE 1 - 16,719 RSF

WORK PLACE		People
Private Office		8
Workstation		68
Total		76

MEET		
	Rooms	Seats
Conference Room	10	61
Phone Room	5	8
Total	15	69

SOCIAL		
	Area	Seats
Reception	1	7
Pantry	1	32
Total	2	39

Total Dedicated Desks **76 People**

**Total Collaborative Seats
Open & Enclosed** **108 Seats**

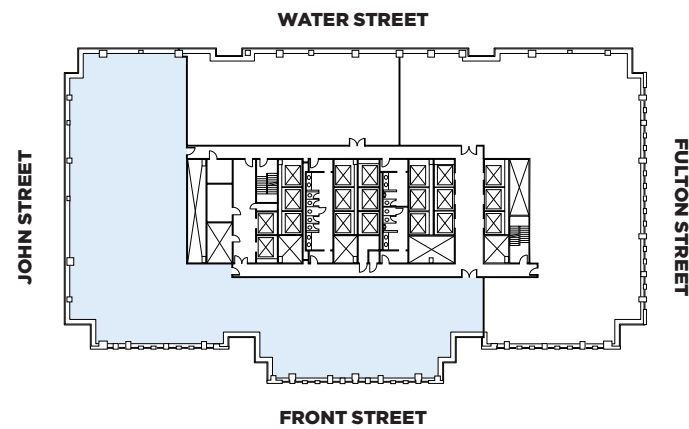

PARTIAL FLOOR 9 BUILD-TO-SUIT SUITE 2 - 13,299 RSF

WORK PLACE		People
Private Office	5	
Workstation	79	
Total	84	

MEET		Rooms	Seats
Conference Room	5	40	

SOCIAL		Area	Seats
Reception	1	3	
Pantry	1	4	
Total	2	7	

Total Dedicated Desks **84 People**

**Total Collaborative Seats
Open & Enclosed** **47 Seats**

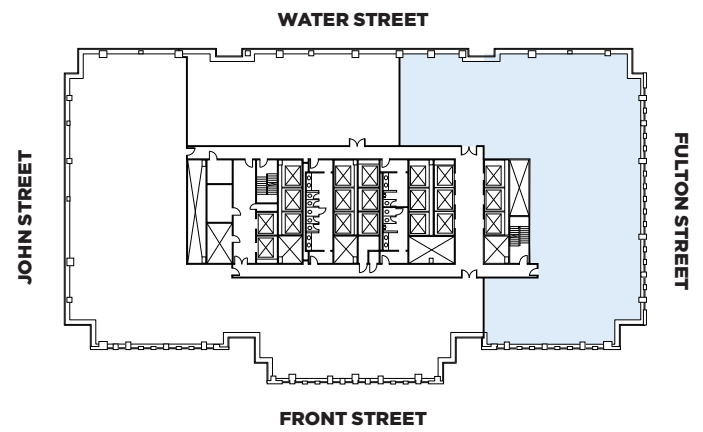

Robert A. Constable
robert.constable@cushwake.com
212 709 0770

Myles Fennon
myles.fennon@cushwake.com
212 841 7532

John Cefaly
john.cefaly@cushwake.com
212 841 5977

Stephen Bellwood
stephen.bellwood@cushwake.com
212 318 9785

Ethan Silverstein
ethan.silverstein@cushwake.com
212 698 2694

PARTIAL FLOOR 9 BUILD-TO-SUIT SUITE 3 - 5,436 RSF

WORK PLACE		People
Private Office	3	3
Workstation	21	21
Total	24	24

MEET		Rooms	Seats
Conference Room	2	14	
Phone Room	1	1	
Total	3	15	

SOCIAL		Area	Seats
Reception	1	7	
Pantry	1		
Total	2	7	

Total Dedicated Desks 24 People

**Total Collaborative Seats
Open & Enclosed 22 Seats**

